

ELS village - MASTER

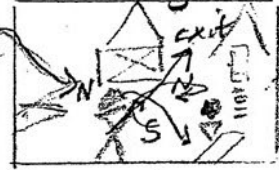

#654-666

Newman enters L to R
Sutton passes, axe in h.h.

Cam Roll	Sound Roll	Slate #	TK	PRT	Time	Lens
(71)	32	95	1		:12	
			2	✓	1:33	
			3	✓	1:35	
			4	✓	1:48	

71	32	95A	1	ng	:21	
			2		:20	
			3	✓	:27	
			4		:25	
			5	✓	:23	



Med 3-S
#654-658

New Snt Willis
Newman exits frame L after #6

	(33)		6	✓	:25	
71	33	95B	1	✓	:53	
(72)			2		:10	
			3	ng	:03	
			4	✓	1:26	
			5	⊙	1:15	

> Best for sound

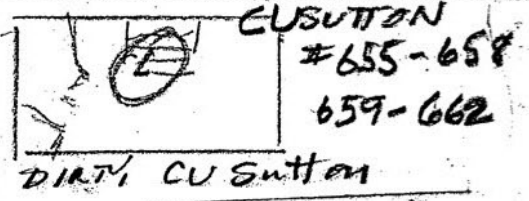

EL SUTTON
#655-658
659-662

DIRTY CU Sutton

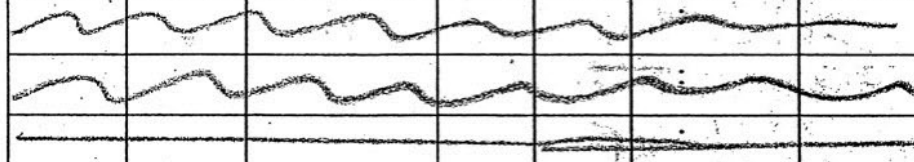
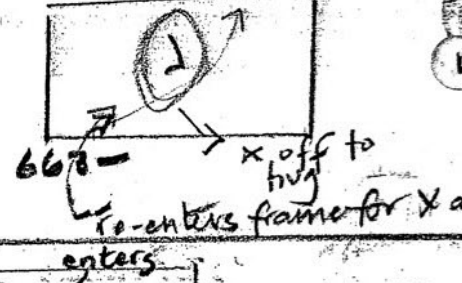

72	33	95F	1	✓	:41	
			2	⊙	:44	
			3	✓	:47	

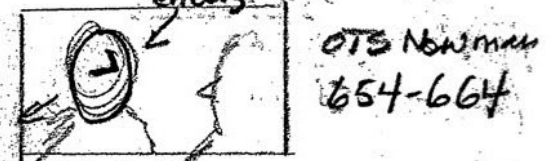

OTS Newman
654-664

OTS NEWMAN
enters R to L (does not match 95D)
#664- Eye direction R to L

73	33	95H	1		:10	
			2		:11	
			3		:12	
			4		:09	
			5	⊙	:11	



Med WILLIS #664
RISES exits SL

73	mos	95L	ser	✓	:	
----	-----	-----	-----	---	---	--

INSERTS of STEW